



## **Manufacturers of Galley Equipment**

**ALUMINOR**  
since 1929

ALUMINOR

**ALUMINOX**



**ALUMINOX**





## Our company

### A history that begins from 1929...

In 1929, Emmanuel Chiladakis founded a small company for producing equipment for commercial kitchens.

Nowadays, after a long presence of more than 70 years in the market, ALUMINOX has acquired a long-term experience in high quality, technologically advanced products and their support.

The factory, covering an area of 6.800 m<sup>2</sup> of the total 13.000 m<sup>2</sup> company owned area, is in operation since 1989 in Koropi Industrial Zone and it is equipped with automatic production machines of the latest technology

Cooperating with Aluminox results to:

- Flexible production that can be customized according to your specific project.
- Direct contact with the person in charge of your project/s. Your requests is our top priority and we make sure that we meet your demands
- Aluminox products are exported all over the world. In 4 continents, consequently:

1. [EUROPE](#) (Germany, Italy, France, Spain, Portugal, Norway, Finland, Poland, Croatia)
2. [U.S.A](#)
3. [ASIA](#) (China, South Korea, Japan, Singapore)
4. [AFRICA](#) (South Africa, Egypt)







# ALUMINOX



## Export

### **Aluminox manpower is 85 people**

We believe that only through continuous education of our staff we can achieve successful progress:

In Aluminox you can find people with specialization in:

- Lay out drawings regarding mass foodservice facilities.
- Customer service
- Mechanical engineers for customized products.

In 2008 Aluminox USA followed.

In 2010 Aluminox is expanding with a new Logistics Center in China.



# Reference List

**ALUMINOX clientele is covering different types of vessels from Mega Yachts to Ferries until Floating Platforms and Cargos.**  
**Below you can find an indicative list from vessels built in shipyards all over the world.**

Shipbuilder	Hull	Owner	DWT	Type
<b>Cargo vessels</b>				
SWS	1157	Anangel	114.500dwt	BC
SWS	1158	Anangel	114.500dwt	BC
SWS	1163	Anangel	114.500dwt	BC
SWS	1164	Anangel	114.500dwt	BC
Ouhua zhenjiang	606	Evalend shipping	37.000dwt	BC
Ouhua zhenjiang	607	Evalend shipping	37.000dwt	BC
Ouhua zhenjiang	608	Evalend shipping	37.000dwt	BC
Ouhua zhenjiang	609	Evalend shipping	37.000dwt	BC
Ouhua zhenjiang	610	Evalend shipping	37.000dwt	BC
Daesun	SB495	Navios Management	50K	PC
Daesun	SB496	Navios Management	50K	PC
Daesun	SB497	Navios Management	50K	PC
Daesun	SB498	Navios Management	50K	PC
Daesun	SB508	Navios Management	50K	PC
Daesun	SB509	Navios Management	50K	PC
Daesun	SB510	Navios Management	50K	PC
Hyundai Heavy Industries	1312	Poseidon Shipping Co	73,700	BS
Hyundai Heavy Industries	1313	Poseidon Shipping Co	73,700	BS
Hyundai Heavy Industries	1526	Zim Israel Navigation Co	54,740	CN
Hyundai Heavy Industries	1586	Sovcomflot	159,200	TN
Hyundai • Samho Shipyard	222	American Eagle Tankers	164,600	TO
Hyundai • Samho Shipyard	248	Marmaras Navigation Ltd	164,600	TO
Hyundai • Samho Shipyard	268	Marmaras Navigation Ltd	164,600	TO
Ishikawajima-Harima H.I.	3088	P&O Nedlloyd BV	82,700	CN
Izar Shipyards	C399	Decon S.A.	-----	PV
JSC Damen Shipyards Okean	9116	UKRSHIPPING LTD.	6300	-----
Jiangyang	99137	Brave Maritime Corp.	74,500	BS
Kvaerner Masa-Yards	1340	Superfast Ferries (Attica)	GT 28,800	PV
Liaoning Bohai Shipyard	BH410-8	Transmed Shipping	174,000	BS
Mitsui Eng. & Shipbuilding	1464	Antares Shipping	75,000	BS
Chantiers De L'E Atlantique	830	Frence Navy & Ifremer	-----	QN
Namura Shipbuilding Co	998	Angelakos Ltd	74,000	BN

## Navy vessels

Chantiers De L'E Atlantique	830	Frence Navy & Ifremer		
Royal Dutch Navy	Hr. Ms. Piet	Heijn		
STOCZNIA MARYNARKI	621	POLISH NAVY		
China Shipbuilding Co •	Kao 691	Taiwan Navy		
China Shipbuilding Co •	Kao 694	Taiwan Navy		
China Shipbuilding Co •	Kao 695	Taiwan Navy		
China Shipbuilding Co •	Kao 696	Taiwan Navy		
China Shipbuilding Co •	Kao 697	Taiwan Navy		
China Shipbuilding Co •	Kao 698	Taiwan Navy		
China Shipbuilding Co •	Kao 699	Taiwan Navy		
China Shipbuilding Co •	Kao 700	Taiwan Navy		
China Shipbuilding Co •	Kao 701	Taiwan Navy		
Royal Schelde		Hr.Ms. Piet Heij		
Royal Schelde		Hr. Ms. Crijnsen		

## Passenger vessels

P+S Werften	HN502	SCANDLINES	160m	RORO
P+S Werften	HN503	SCANDLINES	160m	RORO
Daewoo Heavy Industries	7504	Blue Star Ferries (Strintzis)	GT 22,000	PV
Daewoo Shipbuilding	7507	Blue Star Ferries (Strintzis)	GT 10,200	PV



Shipbuilder	Hull	Owner	DWT	Type
<b>Passenger vessels</b>				
Fincantieri Cantieri Naval Italiani	6119	Neptune Shipping Agency	GT 27,500	PV
Fincantieri Cantieri Naval Italiani	6120	Neptune Shipping Agency	GT 27,500	PV
Flender Werft	682	Superfast Ferries (Attica)	GT 29,000	PV
Flender Werft	683	Superfast Ferries (Attica)	GT 29,000	PV
Fosen Mekaniske Verksteder	69	ANEK Lines	GT 30,000	PV
HDW	359	Superfast Ferries (Attica)	GT 29,800	PV
HDW	360	Superfast Ferries (Attica)	GT 29,800	PV
Kvaerner Masa-Yards	1340	Superfast Ferries (Attica)	GT 28,800	PV
Perama shipyards		Aegean experiences		CV
Fosen Mekaniske Verksteder	69	ANEK Lines	GT 30,000	PV
Fosen Mekaniske Verksteder	70	ANEK Lines	GT 30,000	PV
Fosen Mekaniske Verksteder	74	STENA LINES	-----	PV
Fosen Mekaniske Verksteder	75	STENA LINES	-----	PV
Port Said Shipping Co. El Salam	89	Passenger/Vehicle Ferry		
Port Said Shipping Co. El Salam	91	Passenger/Vehicle Ferry		
Port Said Shipping Co. El Salam	95	Passenger/Vehicle Ferry		

Shipbuilder	Name	Type
<b>Passenger vessels</b>		
Perama Shipyards	Aegean Odyssey cruise vessel	
Yachtley Shipyards	Private Yacht 76 meters	
Neorion Syros Shipyards	Liveras Yachts	
Neorion Syros Shipyards	Liveras Yachts	
Marine Accommodations	inc Giant • USA Cruise Ship	
Marine Accommodations	inc Interlake • USA Cruise Ship	
Perama Repairing Zone	Flamenco Cruise Ship	
Perama Repairing Zone	Oceanic Explorer Cruise Ship	
Azmy El Badrawy Yards	Prestige Floating Hotel • Nile	
Azmy El Badrawy Yards	Solitaire Floating Hotel • Nile	
Azmy El Badrawy Yards	Style Floating Hotel • Nile	
El Sholkamy Shipyard Glory	Floating Hotel • Nile	
El Sholkamy Shipyard King Tut	Floating Hotel • Nile	
El Sholkamy Shipyard King Tut II	Floating Hotel • Nile	
El Sholkamy Shipyard King Tut III	Floating Hotel • Nile	
El Sholkamy Shipyard Senouhe	Floating Hotel • Nile	
El Sholkamy Shipyard Telestar II	Floating Hotel • Nile	
Perama shipyards	Dolphin Voyager • Cruise ship	
Alfa shipyard eleusis	Turama • private yacht	
Perama shipyards	Omega • private yacht	
Perama shipyards	Sirius • private yacht	

## Floating Platforms and Special Vessels

Astilleros Espanoles	Cairu	Platform Supply Vessel
Astilleros Espanoles	P47	Platform Supply Vessel
I.H.C. Beaver Dredgers	2283	Abu Dhabi Cutter Suction Dredger
I.H.C. Beaver Dredgers	Samsung Express	Wheeldredger
I.H.C. Beaver Dredgers	Amazona	Suction Hopper Dredger
I.H.C. Holland	Dzelme	Hopper Dredger
I.H.C. Holland Ham	311	Hopper Dredger
Royal Dutch Navy	Hr. Ms. Blommendal	Oceanographic Vessel
Royal Dutch Navy	Hr. Ms. Zeefakkel	Education/Training Ship
Royal Dutch Navy	Hr. Ms. Buyskes	Hydrographic Ship
Royal Dutch Navy Hr.	Ms. Tydeman	Oceanographic Vessel
Royal Dutch Navy Hr.	Ms. Blommendal	Oceanographic Vessel
ALSTOM Chantiers Atlantique	T80 IFREMER	GT 4,000 Q





Main Galley Cruise Ship

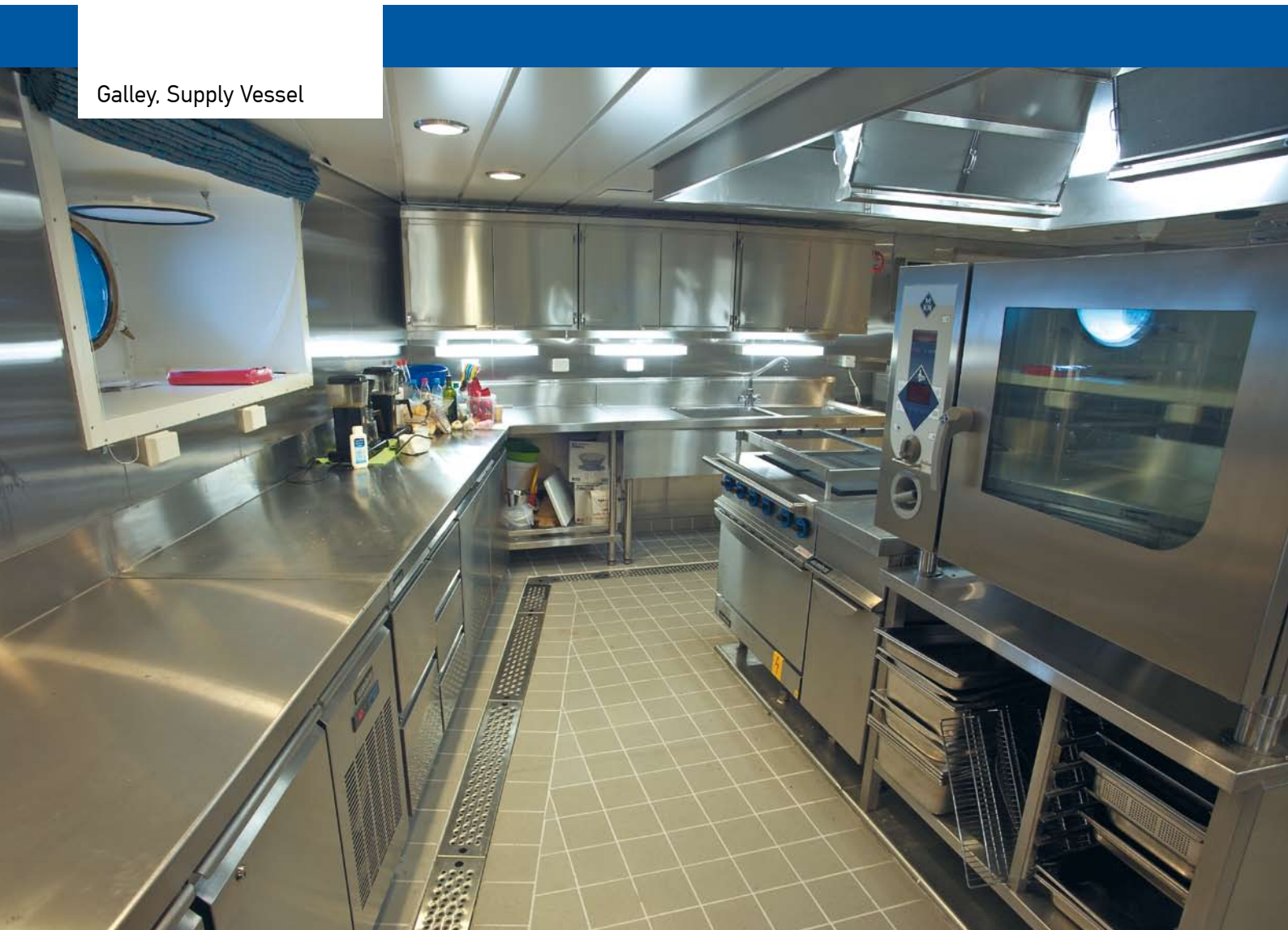

Galley, Supply Vessel





Bar Dining Area Cruise Ship

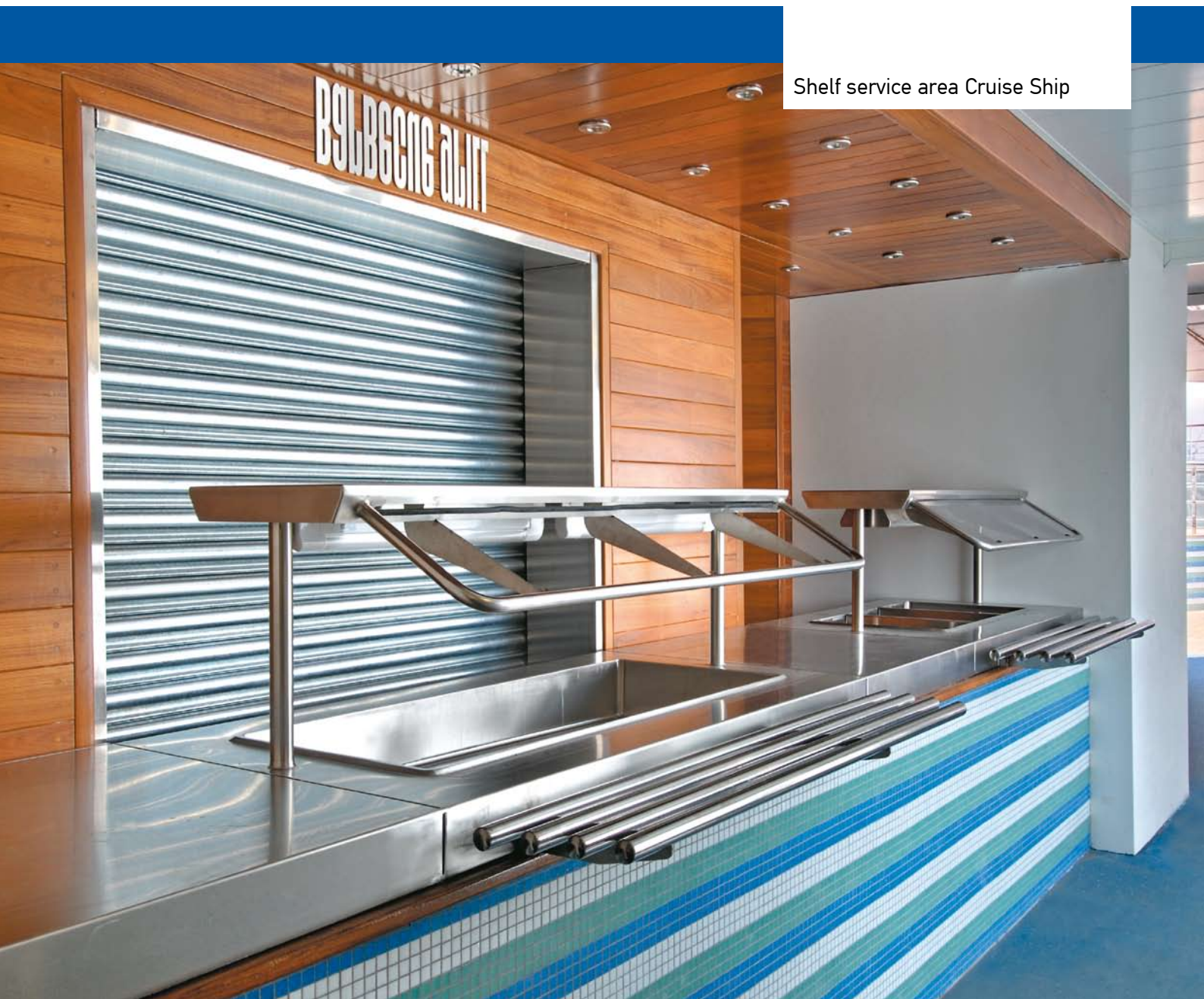

Shelf service area Cruise Ship



## Our know-how is our most valuable asset and we would like to share it with you

### Aluminox offers the complete project concept.

- That means that we can participate with the owner or the yard at any stage a project.
- We can be with you at the very early stages when you prepare your budget or when you make the layout arrangement drawings.
- When the designs are prepared from your side we are flexible enough to adjust our proposals and products according to your design and of course we can install and start up the equipment we offer you.
- Finally, our customer service stays with you all the way ensuring that you have the best possible after sales service.
- We have specialized people in key areas of the company and in this way we can provide quick and efficient service.
- In a project we produce 60%-80% of the equipment on board. In this way we control both the quality and the aesthetics and the finished result shows a unified design.
- We can provide you with turn-key delivery together with our network of cooperators and adopt in the way you prefer the job to be done (for example through a module based system). We can comply with all regulations, Norsok, USPH as all of our products fulfill the highest quality requirements.

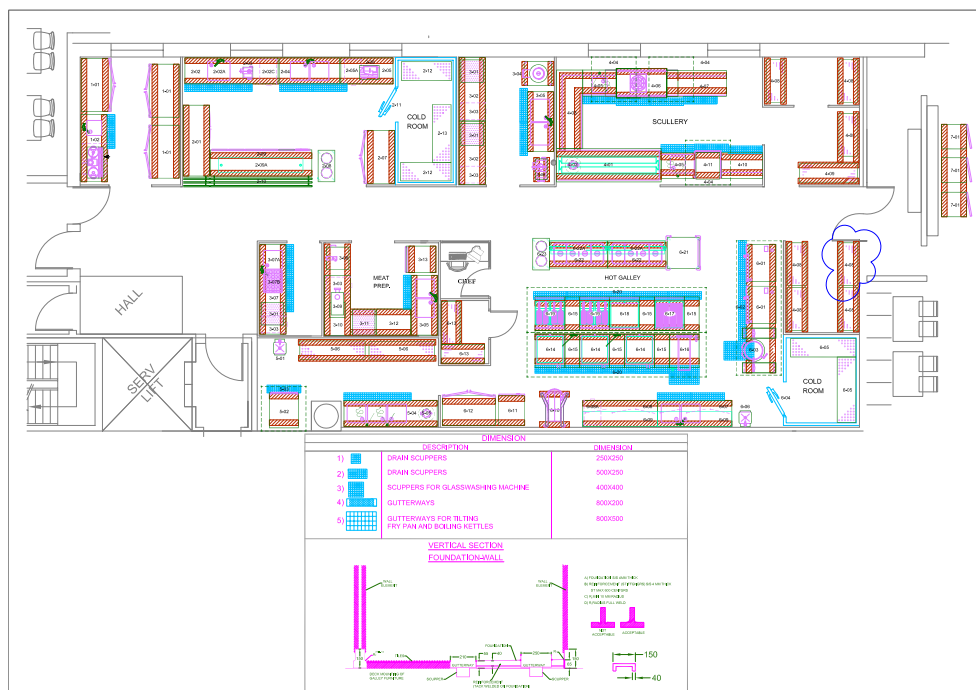





# Our Products

**Aluminox can offer a variety of products.**

**All of our appliances have the CE approval so that they comply with the European Community quality standards, and our production procedure is ISO 9001 certified.**

After a long-term experience, we have developed our production to include constructions of very strict regulations such as the United States' Public Health Specifications (U.S.P.H.).

**Our range of products includes the following categories:**

- **Preparation Equipment**
- **Cooking Equipment**
- **Food Serving Equipment**
- **Dish Washing Equipment**
- **Bar & Pantry Equipment**
- **Refrigeration & Laundry Equipment**
- **Self Service & Stainless Steel Furniture**

- **High quality-long durability**
- **Distinctive design**
- **Superior Performance**

ISO 9001:2000 by ABS



H.A.C.C.P. NSF U.S.P.H.

# ALUMINOX



# Aluminox Production Range



Electric Ranges 70 and 90 line with square or rectangular plates



Electric Griddles 70 and 90 line smooth or ribbed surface or half and half





**Electric Tilting Pans from 60 to 130 liters**



**Electric Boiling Pans from 60 to 150 liters**



# ALUMINOX



Electric High Pressure Tilting Kettles from 90 to 150 liters



Electric Pasta Cookers  
single or double well



Electric ovens with 1 to 3 floors  
with hot cupboard or s/s base.



# Aluminox Production Range



Mixers all in s/s manufactured from 20 to 60liters



Hot cupboards and bain maries available in different sizes

# ALUMINOX



Reach In refrigerators and counters in many combinations.  
All in s/s inside outside

S/S furniture all in s/s AISI 304 compatible with the highest sanitation  
standards, USPH, HACCP.







# Our Cooperators



*Master of Performanc*

**MKN**

Combi Steamers



**Hobart**

Dishwashers



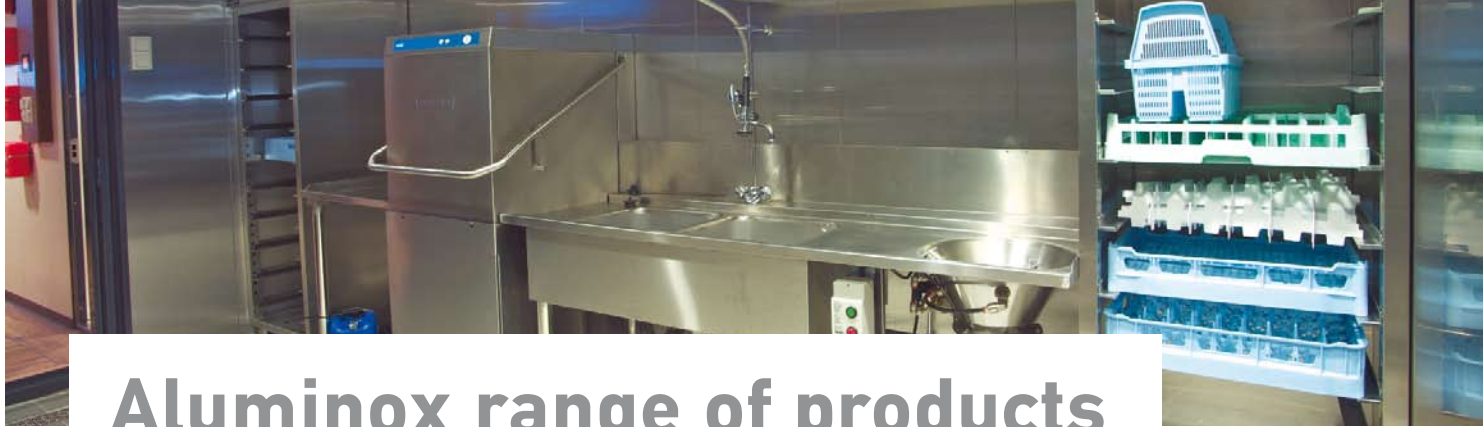

# Aluminox range of products

Aluminox range of products in terms of complete project delivery includes also the following categories:

- **Small Preparation Equipment (Slicers, meat mincers, cutters, mixers etc)**
- **Bar & Pantry Equipment (Coffee machines, blenders, toasters, ice cube machines etc)**
- **Laundry Equipment (Washers, Dryers, Ironers etc)**





**ALUMINOX**



**ALUMINOX**



# ALUMINOX

## ALUMINOX

33, Ifestou str., 194 00 Koropi Industrial Zone  
Tel: +30 210 6622111, Fax: +30 210 6623377  
marine@aluminum.gr, [www.aluminum.gr](http://www.aluminum.gr)